

ALL SAINTS'

EPISCOPAL CHURCH

Total Proposed Capital Campaign Goal: \$570,000

"I am about to do a new thing; now it springs forth, do you not perceive it? I will make a way in the wilderness and rivers in the desert."

(Isaiah 43:19)

"What might the new thing that God is working among us look like? Where have you seen it emerging in your parish or your wider community?..."

*—The Rt. Rev. A. Robert Hirschfield,
Bishop of New Hampshire*

Excerpt from the Invitation to the 2013 Convention

Gifts Essential Chart

This chart illustrates the size and number of gifts necessary for a successful \$570,000 capital campaign.

Size of Gift	Number Needed	Cumulative Total	Monthly (over 3 years)
\$100,000	1	\$100,000	\$2,778
\$75,000	1	\$175,000	\$2,083
\$50,000	1	\$225,000	\$1,389
\$25,000	2	\$275,000	\$694
\$15,000	4	\$335,000	\$417
\$10,000	6	\$395,000	\$278
\$5,000	15	\$470,000	\$139
\$3,000	19	\$527,000	\$83
\$1,000	22	\$549,000	\$28
Less than \$500	Many	Goal Achieved	Variable

LEADERSHIP

The Reverend Jamie L. Hamilton, *Rector*
The Reverend Sandi Albom, *Curate*
Jeffrey L. Fuller, *Organist and Choirmaster*

2017 Vestry:

Phil Suter, *Senior Warden*
Greg Naudascher, *Junior Warden*
Christina Meinke, *Treasurer*
Philip Huckins, *Clerk*

John Catlin
Joan Cunningham
Pam Everson
Beth Healy
Barbara Kaufmann
Lara Niemela
Madelyn Morris
Autumn Roberts
Sally Steere

"Not in the heart of a crowded city but in a hollow of the New Hampshire country there stands All Saints', Peterborough, a little Church, perhaps the most perfect of its size in America. It is in the truest sense a Memorial Church, for the land on which it is built, the Church itself, and all its treasures of Art, have been given in memory of loved ones..."

*—The Toronto Daily
May 2, 1925*

"...So the church stands enduringly and may stand for centuries; built in honour and devotion, for all Christian people, in the Name and to the glory of God, and in faithful remembrance of lives that cannot be forgotten."

*—Ralph Adams Cram, Architect
August, 3, 1923*

On September 16, 1917, the cornerstone for our beautiful village church was laid in memory of loved ones "who have passed beyond the scene of visible activity."

Interrupted for two years during World War I, work resumed and on August 8, 1920, the first regular service was held in All Saints' where there is "light, spaciousness, movement and life." And then on August 5, 1923, The Right Rev. Edward M. Parker, with a host of saints, consecrated our beloved church, chanting the 24th Psalm, "The earth is the Lord's and all that is in it."

One hundred years later, we are celebrating all the blessings we have received from the living stones of our past, called to look to the future to further secure our cornerstone of faith. We are guided by the same vision of the faithful who came before us—to preserve and to foster a holy and sacred place where Christ's love is experienced and shared—now and for future generations.



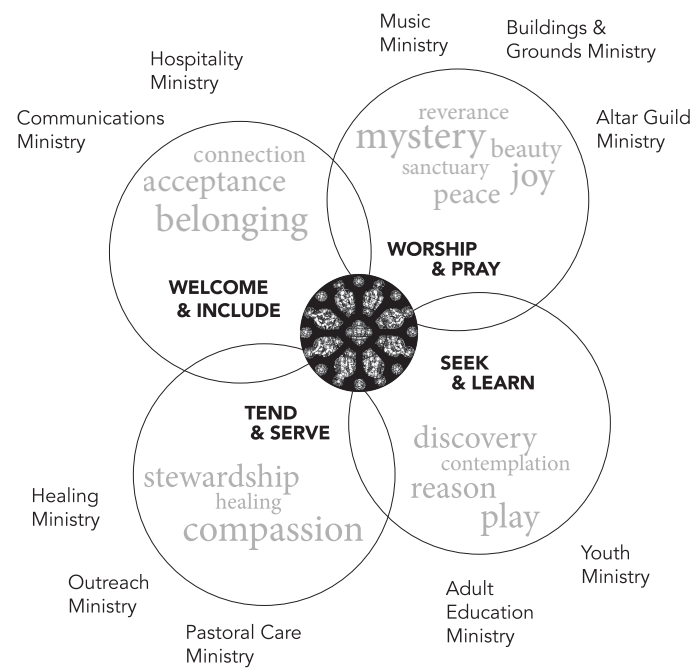

Over the years, All Saints' has often reflected upon how we are being called to participate in God's dream for us, to be agents of God's will, here in our community, in the wider church, and in the world.

Through our recent cottage meeting conversations, we shared our stories of how we have been touched by the Spirit of the Living Lord and why we call All Saints' our home. In those conversations, we identified that we are living into God's dream for us through our ministries (see above).

These four primary areas of ministry emerged through our conversations, as did two common threads: the impact that our beautiful sanctuary and its surrounding campus has on our worship and spiritual experience, and the need to address safety and accessibility issues.

Coming together to have these conversations has been a critical step in the initial phase of discernment of how to best continue to be a vibrant place of worship and Christian community.

As the next part of an initial discernment phase, this feasibility study will provide our leadership with feedback and clarity regarding some identified needs before us as we determine what we, as a parish, are ready and able to address through the possibility of a capital campaign.

We invite you to join us in this exploration by taking some time to review and reflect prayerfully on the following proposed projects in preparation to guide our efforts in moving forward. We look forward to your response.

SUMMARY OF PROJECTS & COSTS

Inspiring Worship

WE ARE continually rejoicing in the beauty of creation, in the mystery of faith, and in the lifting of our voices to sing and pray and worship.

Central to the richness of our liturgy and our music is our 1980 Austin organ. A sophisticated instrument, it relies on electrical connections in the console to signal pipes to speak and wind channels to open. As it has aged, these parts of the console have become unreliable and the tonal quality will benefit from solid-state technology to improve its inner workings and maintain its beautiful sound.

Organ Maintenance: \$20,000

Community Outreach & Service

WE ARE called and are faithfully linked together through fellowship and service to the Church's mission to restore all people to unity with God and each other.

Reynolds Hall enables us to serve each other and our neighbors through gatherings such as our Community Supper—a ministry that has prepared over 40,000 meals in the last ten years.

This ministry and other community activities at Reynolds Hall currently function out of an outdated kitchen. A kitchen upgrade would include: stainless counter tops, dish storage units, a separate freezer and refrigerator, seamless flooring, newly reconfigured island, and accessible food pantries. Also in need of loving attention are: hall entrances, restrooms, slate flooring, carpeting, and windows.

Kitchen upgrade: \$35,000 | Reynolds Hall upgrade: \$15,000

Responsible Stewardship

WE ARE stewards, caring for and conserving the beauty bestowed on us through our buildings and their surroundings.

To be responsive and proactive to the needs of our buildings and grounds, a Capital Reserve Fund needs to be established. This Fund would be an account reserved for long-term capital investment projects or other large and anticipated expenses that will be incurred in the future. With a Capital Reserve in place, we can address rather than defer maintenance.

The key principle of this approach is that the money is collected and segregated to cover the repair or replacement cost of existing common elements and provide for periodic

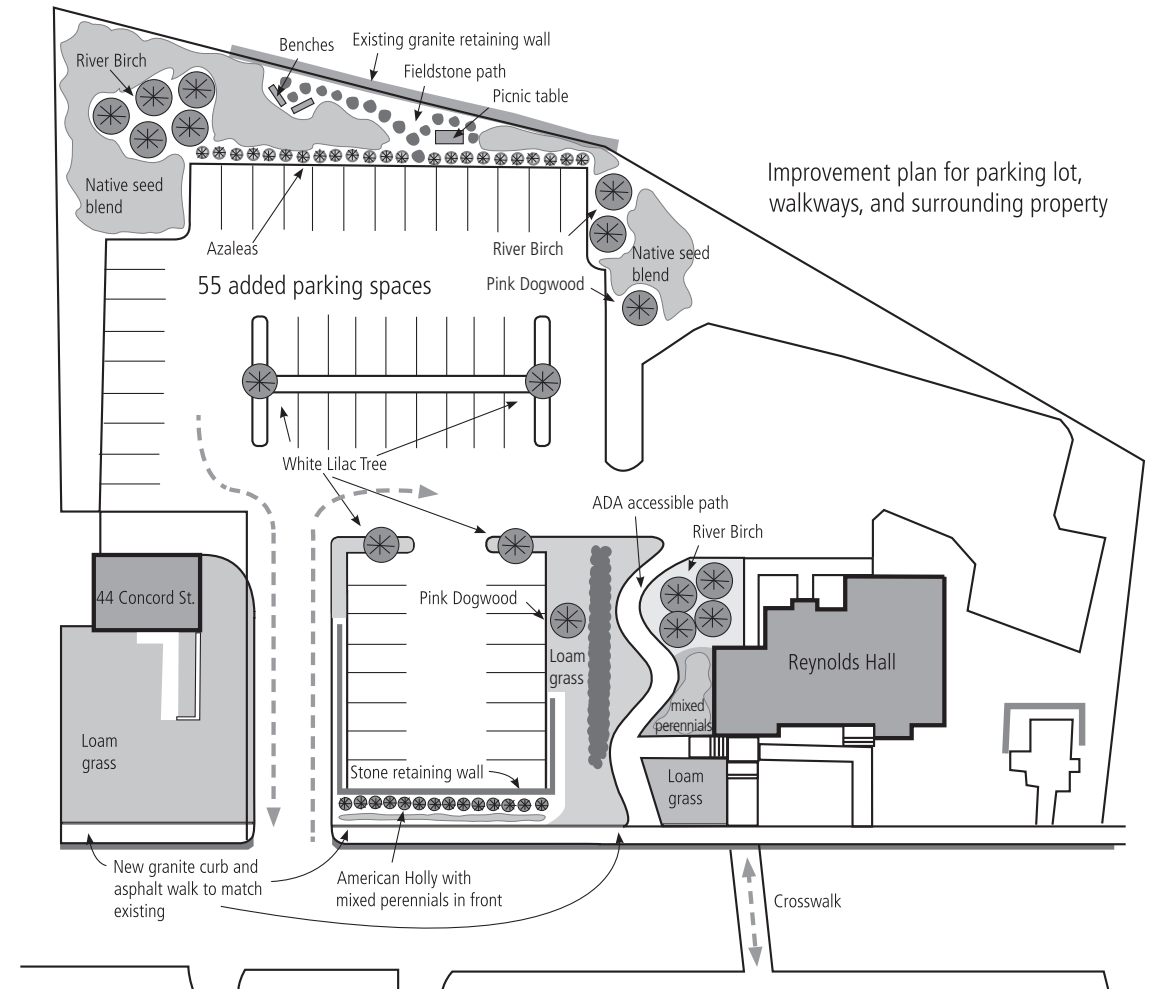

maintenance (such as: painting, maintaining stucco, caulking, power washing, etc.) systematically with a five, ten, and fifteen year plan—protecting capital assets. Capital Reserve Funds are part of a long-term financial plan, with an amount in the range of 1.5 to 2% of gross pledges/collections added each year to the fund.

Seed money to establish a Capital Reserve Fund: \$20,000

Welcoming Access

WE ARE a people of hope, forever committed to coming together to celebrate our love of Christ and of one another and to be a safe place in which all are welcome.

This commitment begins with the opportunity to park and to access our church and campus safely. Improved parking lots and walkways will be safer and more welcoming.

We will be phasing in a variety of improvements to the expanded parking area. The following improvements to the merged parking areas will result in safer entry/exit patterns, attention to environmental concerns, and an aesthetic enhancement to the All Saints' campus. Please see the above diagram as well.

- Replacing the driveway adjacent to Reynolds Hall with an accessible walkway, creating a new two-way driveway

- New grading and paving to address storm water management within the buffer zone of the river.
- Clearing and planting along the existing granite river wall, as well as creating a memorial garden, planting evergreens along Concord St. to separate the parking lot from the street with other plantings interspersed around the parking area.

Repayment of loan to purchase property: \$260,000 | Expanded and improved parking: \$200,000

WE ARE a spiritual home and physical destination for all who are seeking a welcoming, integrated, and diverse Christian community.

Ease of access is essential to our safely coming together and enjoying the gift of being unimpeded in our faith journey. Existing paths and walkways need to be repaired and improved. The availability of handicapped parking spaces needs to be enhanced. Accessibility to the Church, Reynolds Hall, and the Old Parish House needs to be improved.

Addressing Accessibility: \$20,000

Total of proposed projects: \$570,000